



INSTALLATION INSTRUCTIONS
GYTR High Compression Piston
GYT-5D305-00-00
2006-2007 YFZ 450



⚠ WARNING

Please read and understand these instructions completely before installation to avoid possible injury to yourself, or damage to the accessory or vehicle.

CAUTION:

- This installation should be performed by an authorized Yamaha dealer or a qualified mechanic. Some components require information from the model's service manual for proper installation or adjustment. Be sure to have the service manual on hand, if necessary, before proceeding with the installation.
- Alteration of emission-related components constitutes tampering under Federal and State laws and can lead to substantial fines and penalties if used other than in closed-course competition.
- Engine-related competition parts are intended for closed-course racing applications only.

DEALER:

These instructions contain important information for future reference and *must* be given to the customer.

WARRANTY INFORMATION:

- Genuine Yamaha GYTR components are covered by a 90-day warranty against defects in material or workmanship. Labor for replacement of defective components is not covered. See your Yamaha dealer for a copy of the warranty statement.
- The Limited Warranty provided with new Yamaha vehicles has exclusions for certain failures, including those caused by competition or racing use (except YZ and WR motorcycle models) as well as by abnormal strain or abuse. While installation of these GYTR components will not "void" your vehicle's warranty, specific failures adjudged by Yamaha to have resulted from the installation of accessory components or other modifications, or from competition use (except YZ and WR motorcycle models), may not be covered by warranty or Yamaha Extended Service.

The GYTR High Compression Piston Kit is intended for closed-course competition use ONLY.

In order to achieve the longest life and best performance from the GYTR High Compression Piston kit, it is imperative that the following precautions are taken, including, but not limited to:

- Correct jetting for atmospheric conditions, engine state of tune, other performance modifications, riding style, and/or head porting.
- Correct fuel selection to complement jetting, Yamaha strongly recommends 100+ octane fuel. Using a fuel with a lower octane rating can cause detonation, which may lead to catastrophic engine failure.

1. PARTS LIST:

This kit contains the following components. Before beginning installation confirm there are no missing or damaged components.

Item #	Part Number	Description	Qty
1	GYT-5D305-00-00	13:1 High Compression Piston Set	1
*	5TG-11633-10-00	Piston Pin	1
*	93450-22027-00	Piston Pin Clip	2
*	5TG-11603-00-00	Piston Ring Set	1

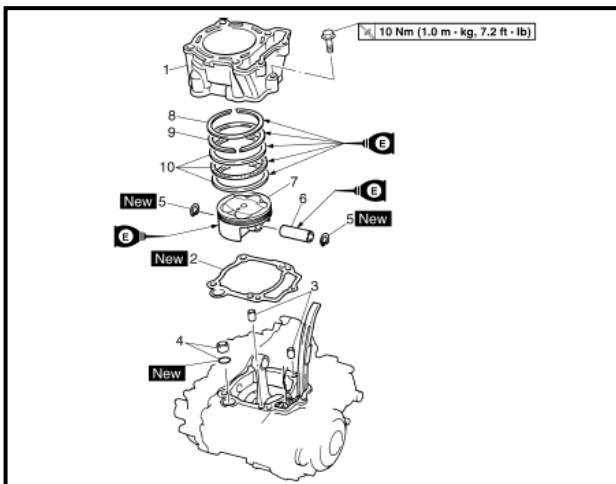
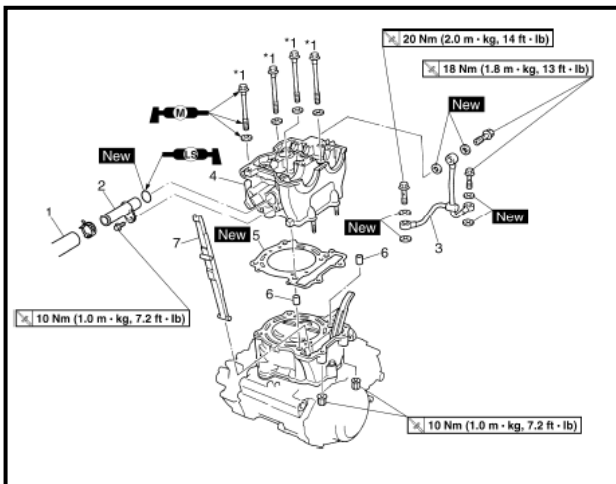

2. PREPARATION:

- Turn off gas valve and check to make sure no fuel is leaking from the gas cap or vent hose before proceeding.

⚠WARNING

Gasoline and its vapors are highly flammable and explosive.

- Place ATV on a secure stand.

3. INSTALLATION:

- The GYTR High compression Piston is a direct replacement for the OEM piston. Make certain to follow all steps in the service manual for proper installation.
- Remove the engine assembly, piston and cylinder following all the steps in the Yamaha Service Manual (LIT-11616-YF-45, LIT-11616-YF-46) under the Engine Section – Section 4.
- Install GYTR High Compression Piston Kit according to the installation procedure in the Yamaha Service Manual.
- When reassembling the engine, a new cylinder head gasket and base gasket (not included) must be used per the service manual.

NOTE:

For best results, replace all gaskets (not included) and washers as indicated in the Service Manual.

Torque all fasteners to factory specifications.

4. MAINTENANCE:

For the best performance and life of your engine, replace your engine oil & filter, and clean your air filter often by following the maintenance procedure recommended in your service manual. In addition, the piston, piston pin, piston pin clips, and piston rings should be inspected every 1,000 km per your Yamaha service manual. If any components are found to be out of specification then the corresponding part should be replaced.

5. CUSTOMER SERVICE:

For further information see your Yamaha dealer.

ESTIMATED TIME TO INSTALL: 3.0 HRS